



**How to set your LockMed Lock Bag  
combination**

**ASA-700, 750**

## To change your lock bag combination, you will need:

- Your lock bag.
- A small flathead screwdriver (between 2.0 and 3.5mm).
- Your new combination.



1. Turn the code to the currently set combination. For a new bag, this is **0-0-0**.



2. Get your flathead screwdriver.



3. Locate the adjustment screw on the side of the combination lock. Push in and turn it clockwise with your screwdriver.

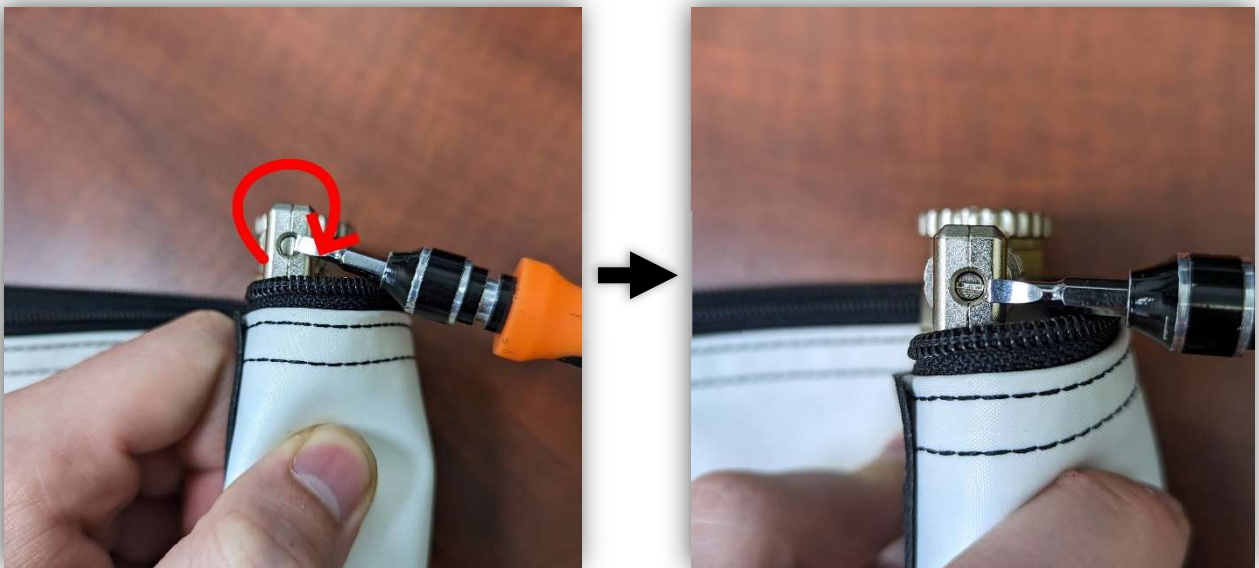

4. With the screw still rotated, change the combination to the code that you want. In this example, I have set the code to **1-2-3**.



5. Once you have set your code, go back to the adjustment screw and turn it counterclockwise.

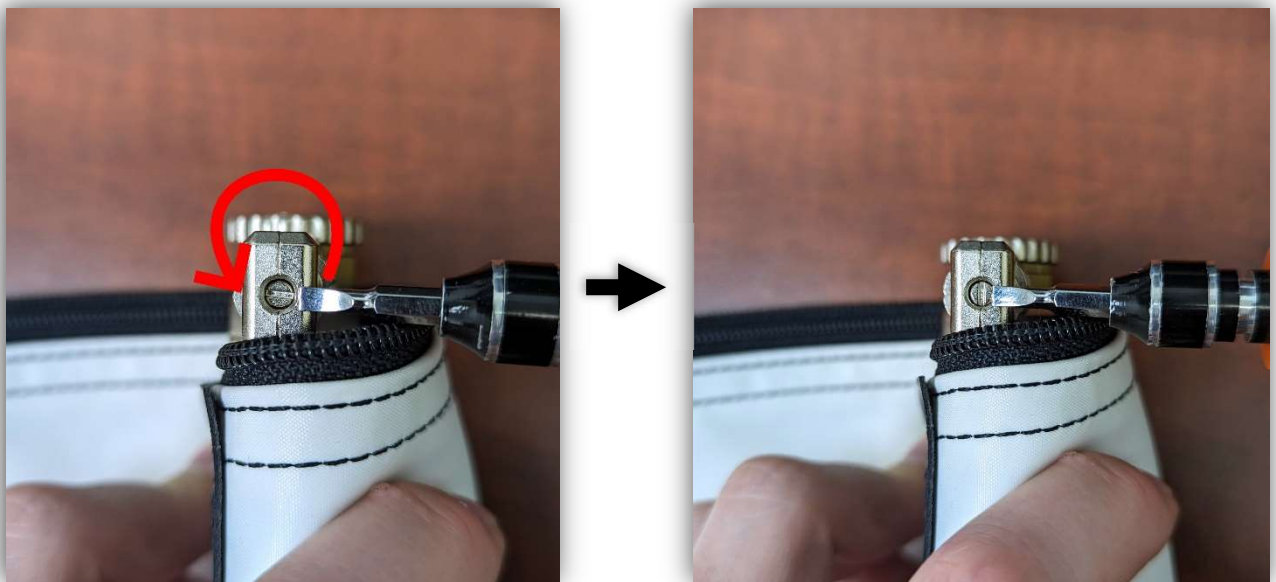



6. The combination is now set and you can open the lock by twisting the thumbwheel clockwise.

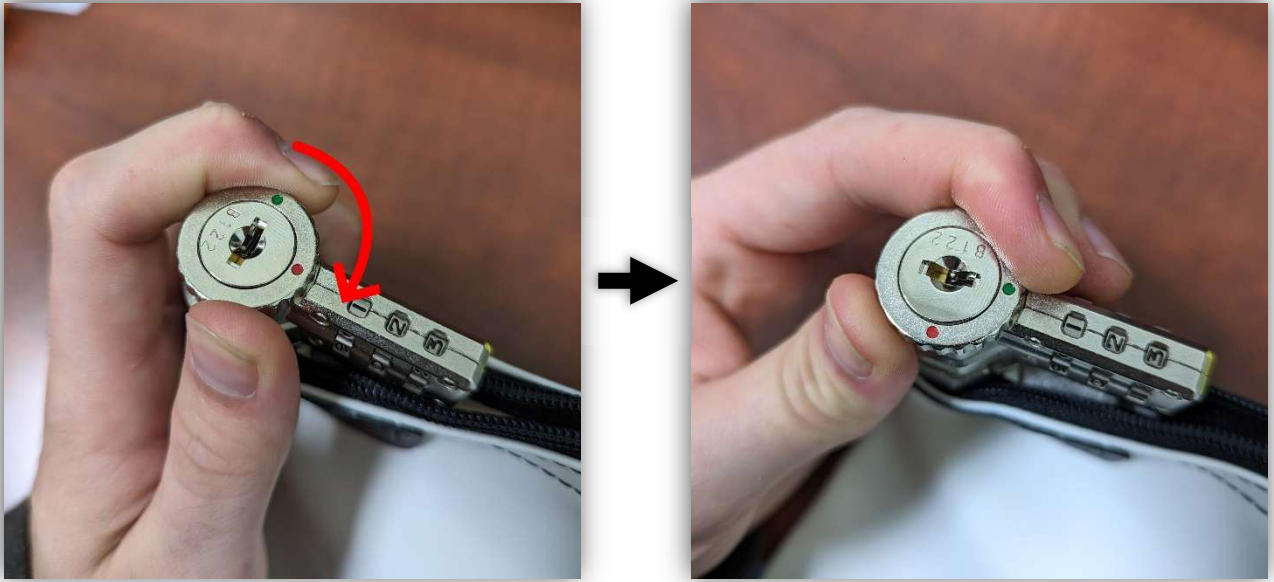

7. Once it is unlocked, the latch will open.



## Locking the bag

1. With the latch open, zip up the zipper next to the lock.



2. Rotate the latch over the zipper.



3. Rotate the thumbwheel so that is now locked.

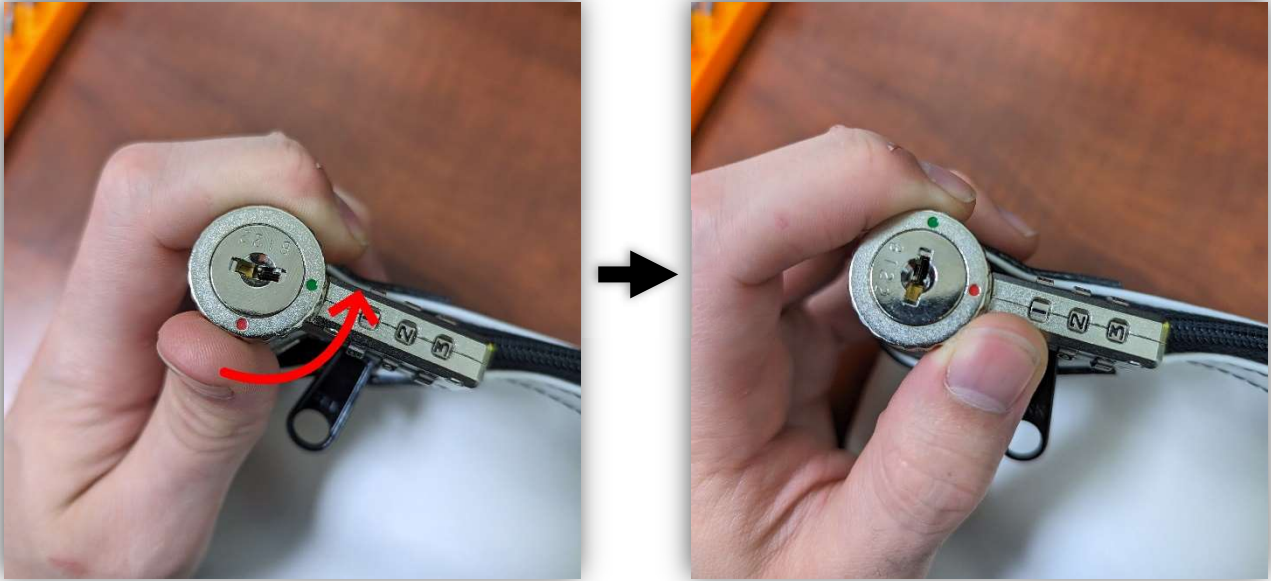

4. Push the latch down until it *clicks*.

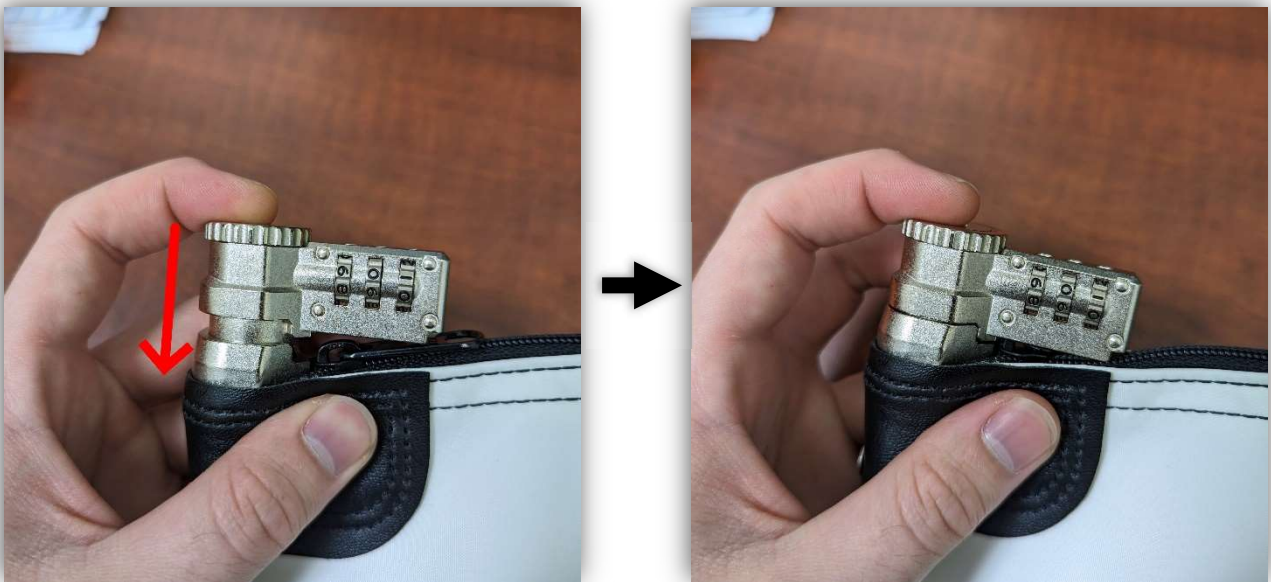

5. Scramble the combination and your bag is now locked.



6. To unlock, rotate the numbers to your combination and follow steps 6 and 7 on page 5.